

Instructions for Connecting to Verizon Jetpack

- Click on the wireless icon to view available wireless networks (laptops)
- Select Settings>Wi-Fi (iPads)
- Select WCS-Hotspot Wi-Fi network
- Enter WaNee456 as the password

*Note – Only Wa-Nee devices assigned to the jetpack by the Wa-Nee IT Department will be able to connect. If you have issues, please call Ryan Mattern at 574-773-4127.

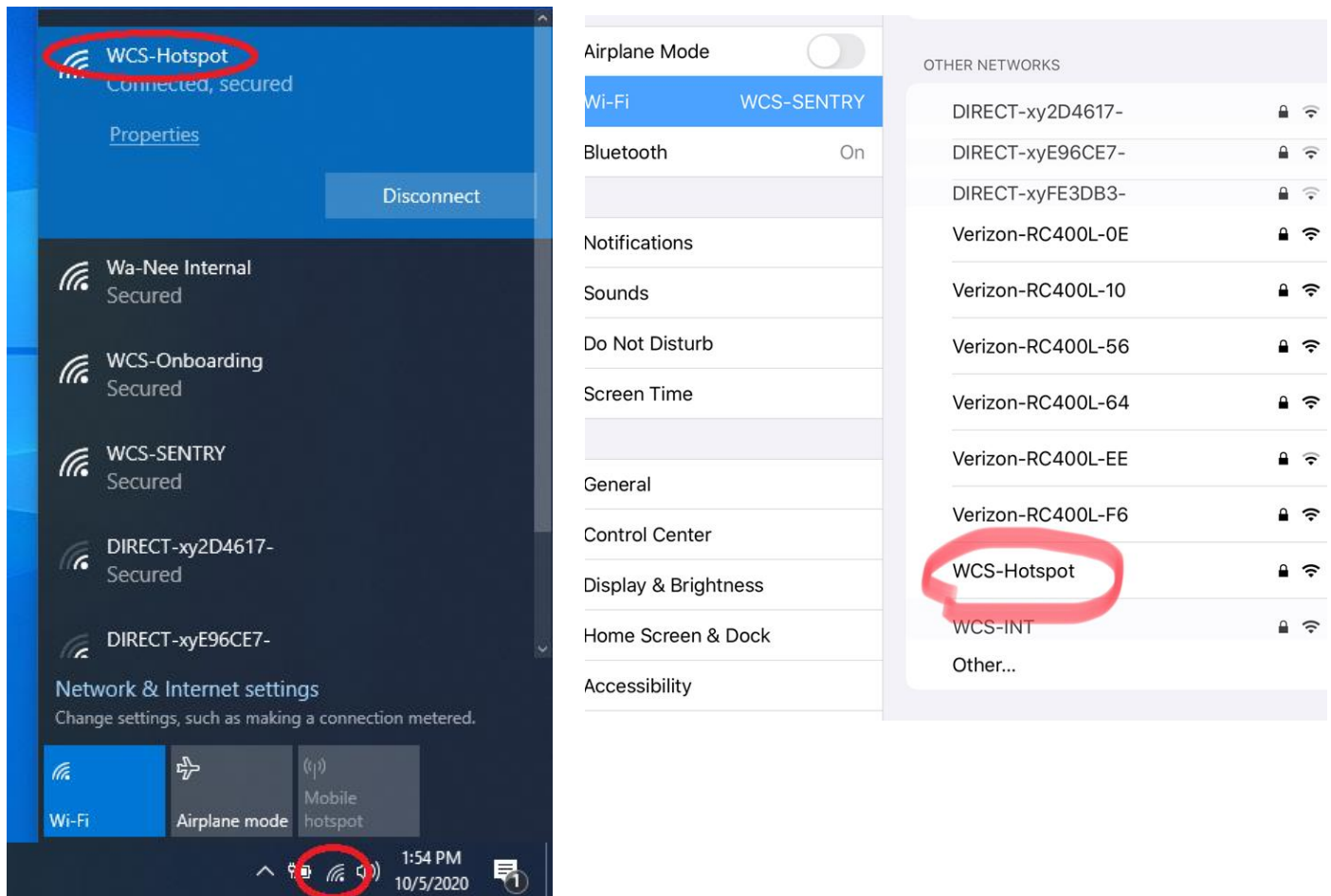

iPad Connection Issues

1. Click the blue i with the circle around it next to WCS-Hotspot
2. Slide the button next to Private Address to the left so that the button is greyed out

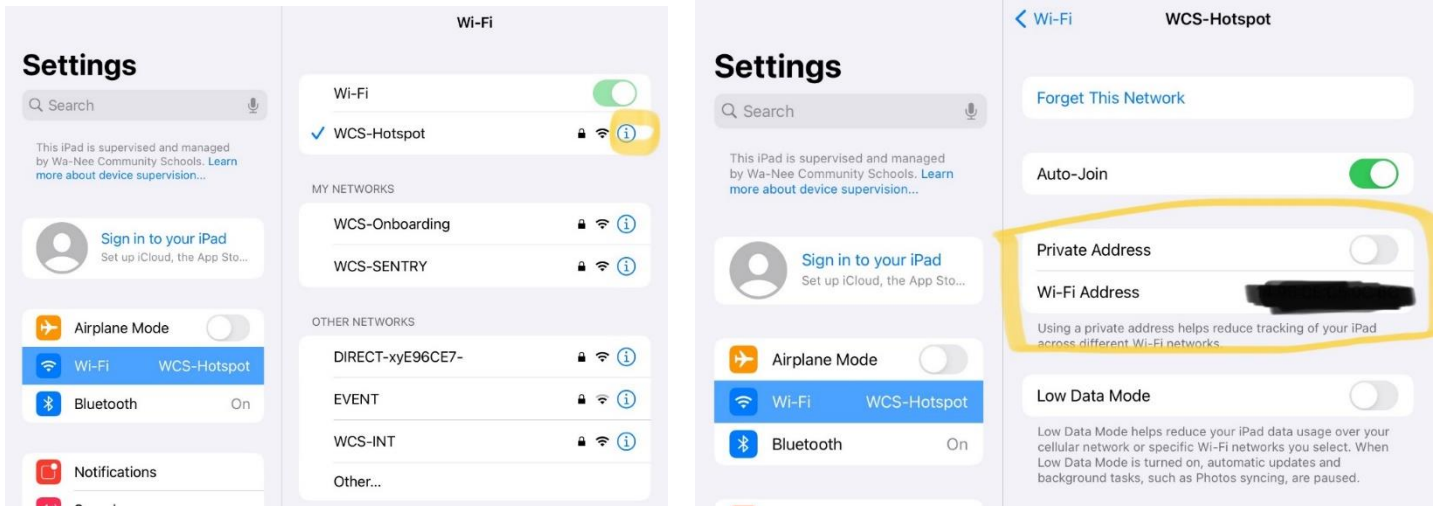

Laptop Connection Issues

1. Open Wi-Fi Settings
2. Make sure "Use random hardware addresses" is off

